



Regeneration and Development Panel
Wednesday, 1st June, 2016 at 6.00 pm
in the Committee Suite, King's Court, Chapel Street,
King's Lynn

Reports marked to follow on the Agenda and/or Supplementary Documents

11. **HLF Heritage Grants Guildhall Complex Project** (Pages 2 - 4)

Contact

Democratic Services
Borough Council of King's Lynn and West Norfolk
King's Court
Chapel Street
King's Lynn
Norfolk
PE30 1EX
Tel: 01553 616394
Email: democratic.services@west-norfolk.gov.uk

Ground Floor

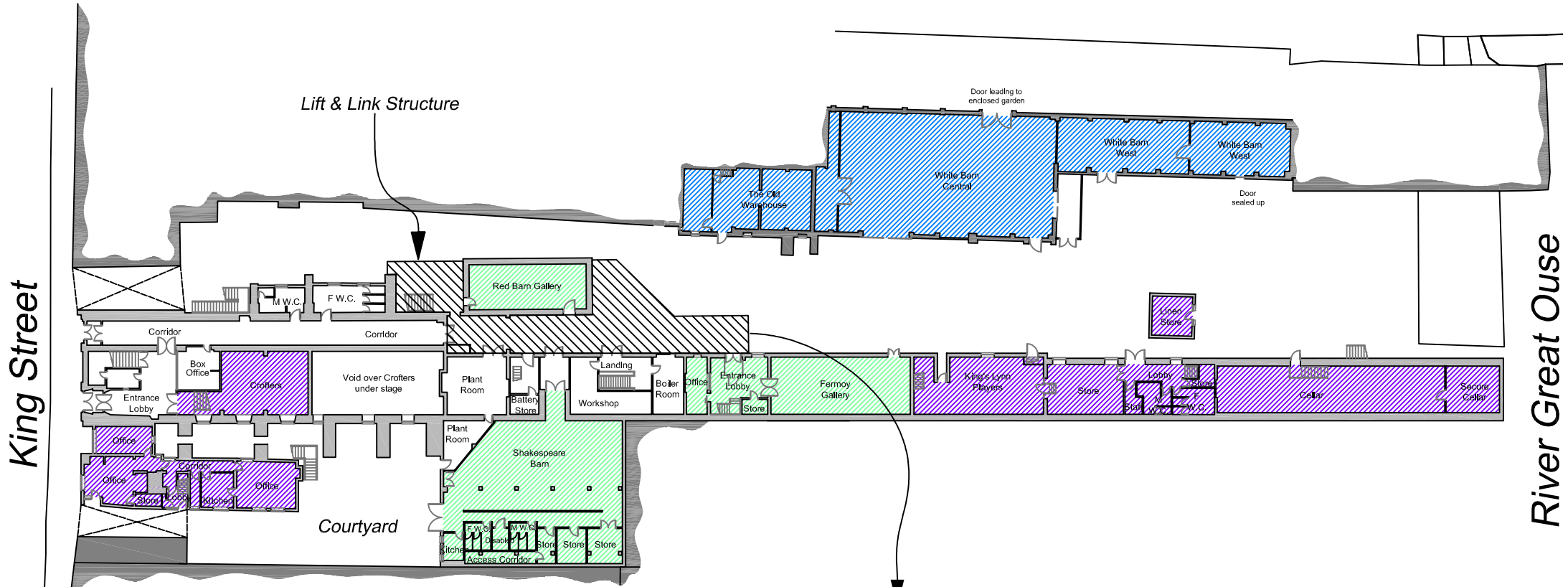

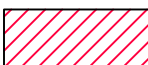
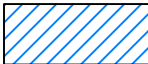
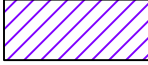
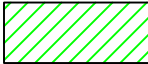

-  - Proposed New Structure
-  - Zone 1 Guildhall
-  - Zone 2 White Barn / Old Warehouse
-  - Zone 3 Commercial
-  - Zone 4 Visual Arts

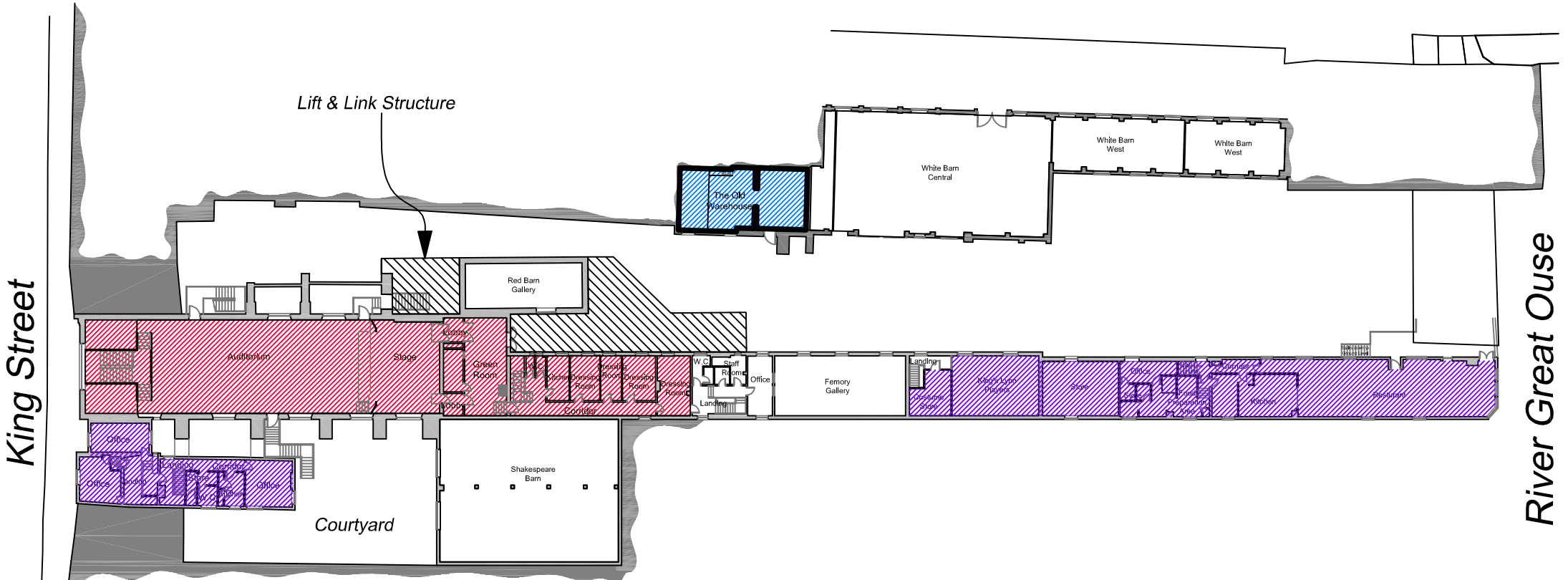

First Floor

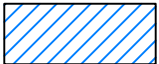
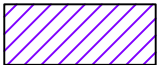
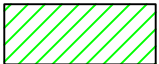

-  - Proposed New Structure
-  - Zone 1 Guildhall
-  - Zone 2 White Barn / Old Warehouse
-  - Zone 3 Commercial
-  - Zone 4 Visual Arts